

Drain: MARGARET O'BRIEN Drain #: 124  
Improvement/Arm: OUTLET RECONSTRUCTION  
Operator: J. LIVINGSTON Date: 5-10-04  
Drain Classification: Urban~~Rural~~ Year Installed: 1980

### GIS Drain Input Checklist

- Pull Source Documents for Scanning
- Digitize & Attribute Tile Drains
- Digitize & Attribute Storm Drains
- Digitize & Attribute SSD
- Digitize & Attribute Open Ditch
- Stamp Plans
- Sum drain lengths & Validate
- Enter Improvements into Posse
- Enter Drain Age into Posse
- Sum drain length for Watershed in Posse
- Check Database entries for errors

JLF  
\_\_\_\_\_  
\_\_\_\_\_  
\_\_\_\_\_  
\_\_\_\_\_  
JLF  
\_\_\_\_\_  
JLF  
\_\_\_\_\_  
JLF  
\_\_\_\_\_  
JLF  
\_\_\_\_\_  
JLF  
\_\_\_\_\_  
JLF  
\_\_\_\_\_

**Gasb 34 Footages for Historical Cost  
Drain Length Log**

Drain-Improvement: MARGARET O'BRIEN - OUTLET RECONSTRUCTION

Drain Type:	Size:	Length	Length (DB Query)	Length Reconcile	Price:	Cost:
OPEN DITCH	-	~ 150'	80'	-70		
DREDGING 55'	-	0'				
SILT TRAP						
TILE OUTLET RELOCATION		0'				

Sum:      ~ 150'      80'      -70      \$3,925.15

Final Report: N/A

Comments:

7-70' OF OPEN DITCH RECONSTRUCTED WITH CROSSPOINTE BUSINESS PARK

---



---



---

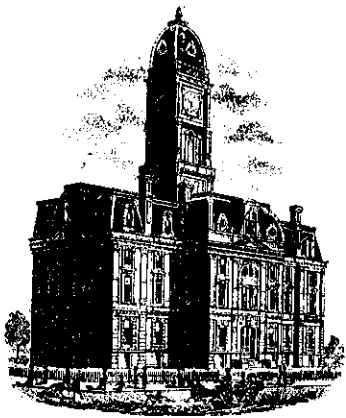

SURVEYOR'S OFFICE  
**Hamilton County**

*Kenton C. Ward, Surveyor*

773-6110 Ext. 19

*Noblesville, Ind. 46060* December 16 1980

TO: Hamilton County Drainage Board

RE: Margaret O' Brien Drain

Attached is a claim from J & W Excavating in the amount of \$529.15 for the Margaret O'Brien Drain. This represents the 15% retainer on the project. I have checked the work and found it to be satisfactory. I believe that the banks will need to be reseeded in the Spring. This can be done under maintenance. I recommend that the claim be approved.

I have spoke to Mr. Thomas of N & W Rail Road today. He has informed me that under the Rail Road is a 12" cast Iron Pipe 36' in length. It is located approximatley 36 feet North of the surface water pipe. In view of this I believe that the pipe under the RailRoad can be cleaned out and the tile replaced as required by the maintenance contractor. Mr. Thomas did request that a RailRoad representative be present while working in the RailRoad R/W.

KCW/no

*Kenton C. Ward*  
Kenton C. Ward-County Surveyor

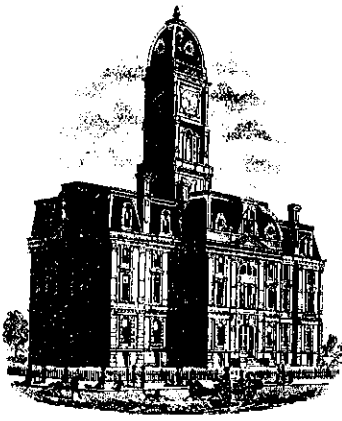

SURVEYOR'S OFFICE  
**Hamilton County**

*Kenton C. Ward, Surveyor*

773-6112 Ext. 19

*Noblesville, Ind. 46060* November 5, 1980

To: Hamilton County Drainage Board

Re: Margaret O'Brien Drain

Today I made the final inspection on the above named drain and found the project to be complete. I recommend to the Board that the attached claim for J & W Excavating in the amount of \$3,000.00 be allowed. The balance of the contract price should be paid in 60 days.

*Kenton C. Ward*  
\_\_\_\_\_  
Kenton C. Ward, Surveyor

KCW/jg

## CONSTRUCTION NOTES

### 1. Benchmarks

- TBM #1 - Nail in tree, 75' South of West crossing - El. 50.0
- TBM #2 - Nail in telegraph pole, 50' South of Railroad culvert, East side El. 46.25

2. Construct a stilling basin on the west side of crossing #1 and line it with 7" graded riprap. Approximately 10 Ton
3. Start dredging the ditch 150' downstream from crossing #2. End dredging at the stilling basin.

#### Channel Dimensions

Bottom width - 4'  
Side slopes - 2:1  
Grade - 0.0016

4. Change the present outlet of the 12' tile to a position just downstream from the stilling basin. A 20' section of CMP and animal guard placed at the end of the tile will protect the outlet. A section of 12" plastic tile may be used to direct the tile towards the ditch.

5. Remove crossing #2 and replace it with 30' of 36" CMP. Backfill the pipe with sand. Set the pipe 6" below the ditch bottom.

6. Repair blow holes on the east side of the railroad tracks. Costy to return back

7. Seed all disturbed acres with - (at the end of each construction day)
  - 30#/acre of Fescue
  - 10#/acre of Rye grass
  - 600#/acre 12-12-12 fertilizer

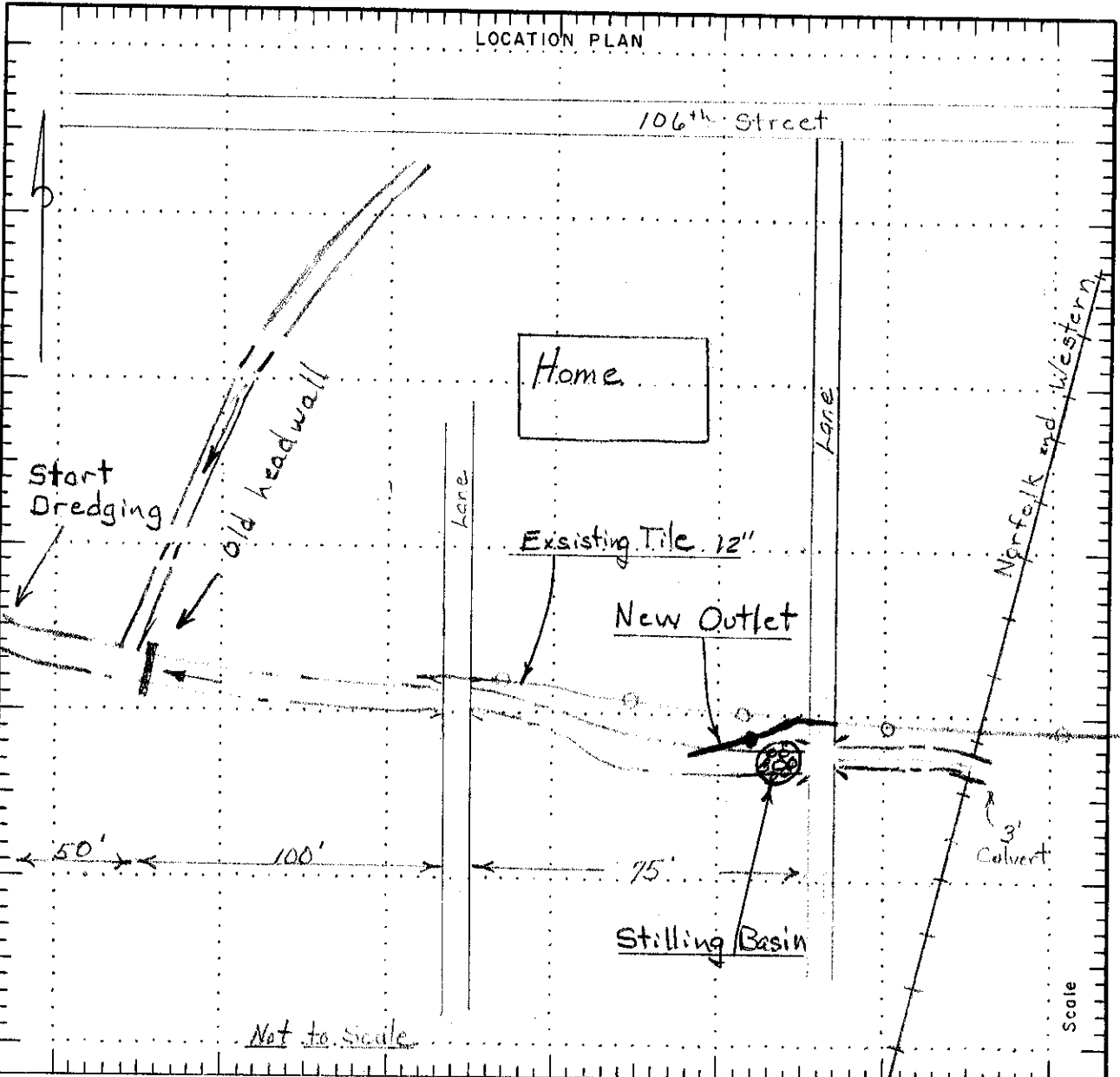

Not to Scale

Scale

— LEGEND —

Farm Boundary	---
Permanent Fence	- x - x - x
Existing Tile Line	- o -
Proposed Tile Line	- ● -
New Tile Installed	- ○ -
Existing Deep Ditch	- :: -
Proposed Deep Ditch	- = -
Existing Shallow Ditch	- > -
Proposed Shallow Ditch	- > -

SECTION Delaware Sec. 12

TOWNSHIP \_\_\_\_\_ RANGE \_\_\_\_\_

COUNTY Hamilton STATE In

COOPERATOR M. O'Brien Local Drain

COOPERATING WITH Drainage Board

SURVEYED BY Ward + Martin

CONSTRUCTION REPORT 23

Date Installed \_\_\_\_\_  
 Contractor \_\_\_\_\_  
 Staked By \_\_\_\_\_  
 Amount \_\_\_\_\_

Remarks: \_\_\_\_\_

SIGNATURE \_\_\_\_\_

DATE \_\_\_\_\_

DRAINAGE PLAN

M. O'Brien Drain

U. S. DEPARTMENT OF AGRICULTURE  
SOIL CONSERVATION SERVICE

Designed J. South Date 5/10/00

Approved by T. Schellenberger

Drawn \_\_\_\_\_

Title \_\_\_\_\_

Traced \_\_\_\_\_

Sheet \_\_\_\_\_ Drawing No. \_\_\_\_\_

Checked \_\_\_\_\_

No. \_\_\_\_\_ of \_\_\_\_\_

USDA-SCS-MILWAUKEE, WIS. 1960

ORDER THIS BLANK DATA SHEET BY DRAWING NUMBER 3-L-45875

ELEVATIONS

46  
45  
44  
43  
42  
41  
40  
39  
38  
37

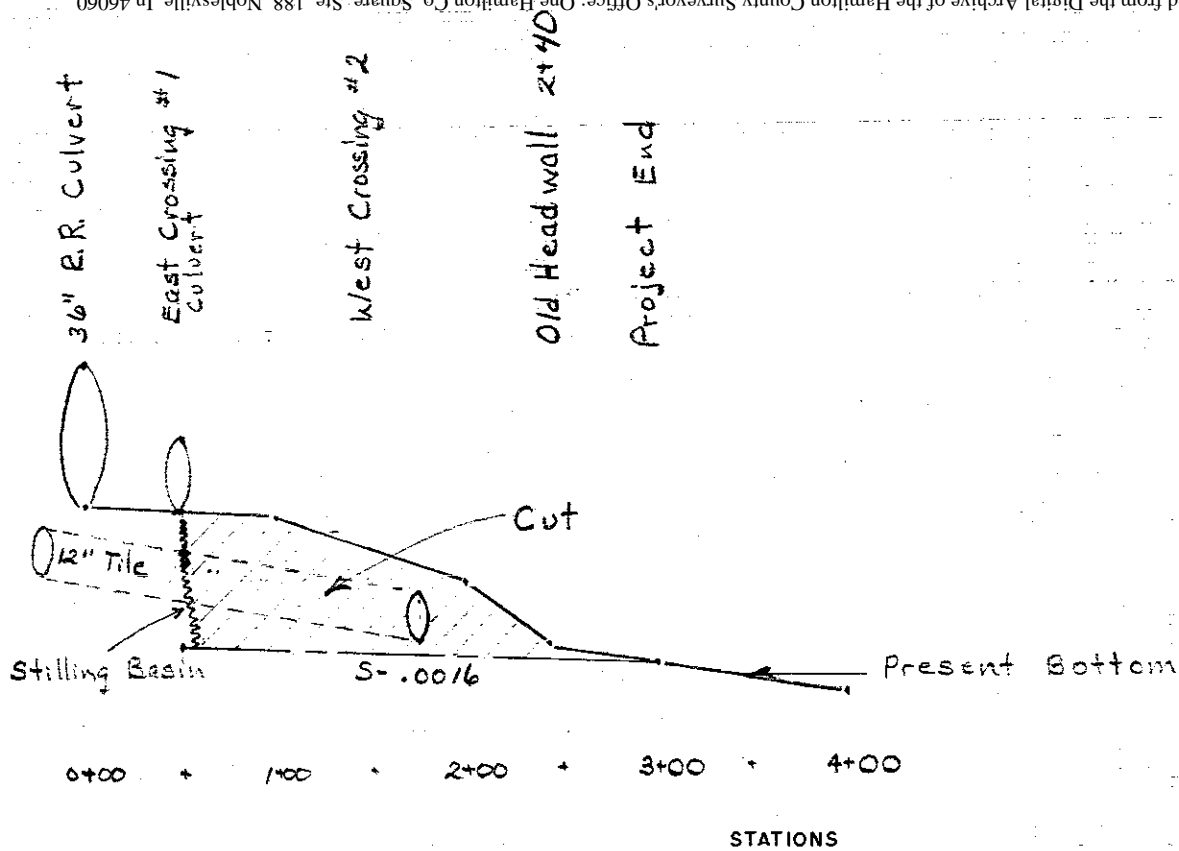

0+00 + 100 + 200 + 300 + 400

STATIONS

DESIGN DETAILS

LINE	STATIONS	DRAIN AREA ACRES	DITCH DIMENSIONS				PIPE SIZE INCHES	GRADE %	DRAIN COEF OR CURVE	VELOCITY Ft/Sec.	CAPACITY	
			DEPTH FEET	TOP FEET	BOTTOM FEET	SIDE SLOPE					REQ'D c.f.s.	AVAIL. c.f.s.
Main	0+50 to 3+00	300	4	-	4	2:1	.16	B	2.7	45	45	

Bench Mark Description:  
 BM #1 Nail in tree, 75' South of West Crossing El=50.0  
 BM #2 Nail in telegraph pole, South of R.R. culvert, Eastside  
 Materials: El. 46.25

REGULAR INSPECTION OF THE DRAIN SYSTEM IS ESSENTIAL. PROMPT REPAIR OF ANY FAILURE WILL KEEP THE SYSTEM IN WORKING ORDER AND MAINTENANCE COSTS LOW.